

The Cottage Garden

Workers on the great English estates in the 16th and 17th centuries often tended their own small, profuse garden plots. Typically just large square beds separated by paths for maintenance, these "cottage gardens" contained favourite herbs, vegetables and flowers growing side by side in a relaxed and casual manner. Today an abundant variety of plants in an informal setting still characterize the overall style of a cottage garden. Other elements also include:

1. minimal or no turf;
2. pathways and patios of flagstone, old brick, gravel and mulch;
3. picket or wrought iron fencing, trellis, birdbaths, garden benches.

In our cottage garden, combinations of native and non-native perennials grow together with a few shrubs, grasses and annuals. Considerations for plant selection include an open, sunny location as well as diversity in colour, texture, form and structure of the plants themselves. This type of garden evolves and changes over time, as new seedlings from neighbouring properties sometimes establish themselves and/or as some plants perform better than others.

Other plants for a cottage garden (in addition to what is shown on the enclosed sketch plan):

SMALL: Pussy Toes, Carpathian Bellflower, Dwarf Iris, Thyme, Pasque Flower, Basket of Gold

MEDIUM: Blazing Star, Baby's Breath, Michaelmas Daisy, Blanket Flower, Blue Flax

TALL: Purple Fennel, Chocolate Snakeroot, Rattlesnake Master, Sea Holly Gazania, Sunflower

WATERWISE GARDEN:
Tranquility Hall
(corner of Powerline Rd. & Francis St.)

For more information about the Waterwise Demonstration Garden, contact the WATER HOTLINE at 519-759-1511.

A partnership project by:



City of Brantford
Water Conservation Program



Brant-Lyn Optimists



WATERWISE
Demonstration
Garden Brochure

COTTAGE GARDEN



Perennials/Grasses:

Key	Latin Name	Common Name
acm	Achillea millefolium	Yarrow
ac	Arabis caucasia sp.	Rock cress
am	Armeria maritima	Thrift
ap	Artemesia "Powis Castle"	Powis Castle sage
bc	Bergenia cordifolia	Heartleaf Bergenia
ca	Calamagrostis arundinacae "Karl Foerster"	Feather Red Grass
cg	Carex glauca	Blue Sedge
cl	Coreopsis lanceolata	Lanceleaf coreopsis
cv	Coreopsis verticilata "Moonbeam"	Threadleaf coreopsis
dg	Dianthus gratianopolitanus sp.	Cheddar pink(s)
ep	Echinacea purpurea	Purple coneflower
er	Echinops ritro	Globe Thistle
gj	Geranium x "Johnson's Blue"	Johnson's Blue geranium
hd	Hemerocallis sp. dwarf	Daylilies (dwarf)
ht	Hemerocallis sp. (tall)	Daylilies (tall species)
hm	Heuchera micrantha "Palace Purple"	Palace Purple Coralbells
lco	Lychnis coronaria	Rose Campion
lcf	Lysmachia ciliata "Firecracker"	Fringe loosestrife
ls	Leucanthemum x superbum "Becky"	Shasta Daisy
mm	Macleaya microcarpa	Plume Poppy
msg	Miscanthus sinensis gracilllis	Maidenhair Grass
ms	Miscanthus sinensis sp.	Maidenhair Grass (variety)
md	Monarda didyma	Bee Balm



Spike Speedwell

Common Name	Key	Latin Name	Common Name
Yarrow	p	Paeonia sp.	Peony varieties
Rock cress	po	Papaver orientale	Oriental Poppy
Thrift	pa	Perovskia atriplicifolia	Russian Sage
Powis Castle sage	pp	Phlox paniculata	Summer Phlox
Heartleaf Bergenia	ps	Phlox subulata	Ground Pink
Feather Red Grass	rf	Rudbeckia fulgida "Goldsturm"	Black-eyed Susan
Blue Sedge	ss	Sedum spectabile "Autumn Joy"	Autumn Joy Sedum
Lanceleaf coreopsis	sb	Stachys byzantina	Lamb's Ears
Threadleaf coreopsis	vs	Veronica spicata sp.	Spike Speedwell
Cheddar pink(s)	Not Keyed	Iris germanica 1 "Immortality", 2 "Dusky Challenger" 3 Blessed Again"	Bearded Iris (all three)
Purple coneflower			
Globe Thistle			
Johnson's Blue geranium	A	Cotinus coggygria "Royal Purple"	Purple Smoke Tree
Daylilies (dwarf)	B	Euonymus fortunei "Vegetus"	Wintercreeper Euonymus
Daylilies (tall species)	C	Juniperus virginiana "Fairview"	Fairview Juniper
Palace Purple Coralbells	D	Rosa rubrifolia	Redleaf Rose
Rose Campion	E	Spiraea japonica "Anthony Waterer"	Anthony Waterer Spirea
Fringe loosestrife	F	Spiraea nipponica "Snowmound"	Snowmound Spirea
Shasta Daisy	G	Buddleia davidii "Blue Knight"	Blue Knight Butterfly Bush
Plume Poppy	H	Picea nidiformis "Little Gem"	Nest Spruce
Maidenhair Grass	I	Lonicera japonica "Halliana"	Hall's Honeysuckle
Maidenhair Grass (variety)	J	Euonymus fortunei "Gaiety"	Gaiety Euonymus
Bee Balm	K	Yucca filamentosa "Bright Edge"	Bright Edge Yucca

Trees/Shrubs/Conifers/Vines:

Key	Latin Name	Common Name
A	Cotinus coggygria "Royal Purple"	Purple Smoke Tree
B	Euonymus fortunei "Vegetus"	Wintercreeper Euonymus
C	Juniperus virginiana "Fairview"	Fairview Juniper
D	Rosa rubrifolia	Redleaf Rose
E	Spiraea japonica "Anthony Waterer"	Anthony Waterer Spirea
F	Spiraea nipponica "Snowmound"	Snowmound Spirea
G	Buddleia davidii "Blue Knight"	Blue Knight Butterfly Bush
H	Picea nidiformis "Little Gem"	Nest Spruce
I	Lonicera japonica "Halliana"	Hall's Honeysuckle
J	Euonymus fortunei "Gaiety"	Gaiety Euonymus
K	Yucca filamentosa "Bright Edge"	Bright Edge Yucca

Cottage Garden

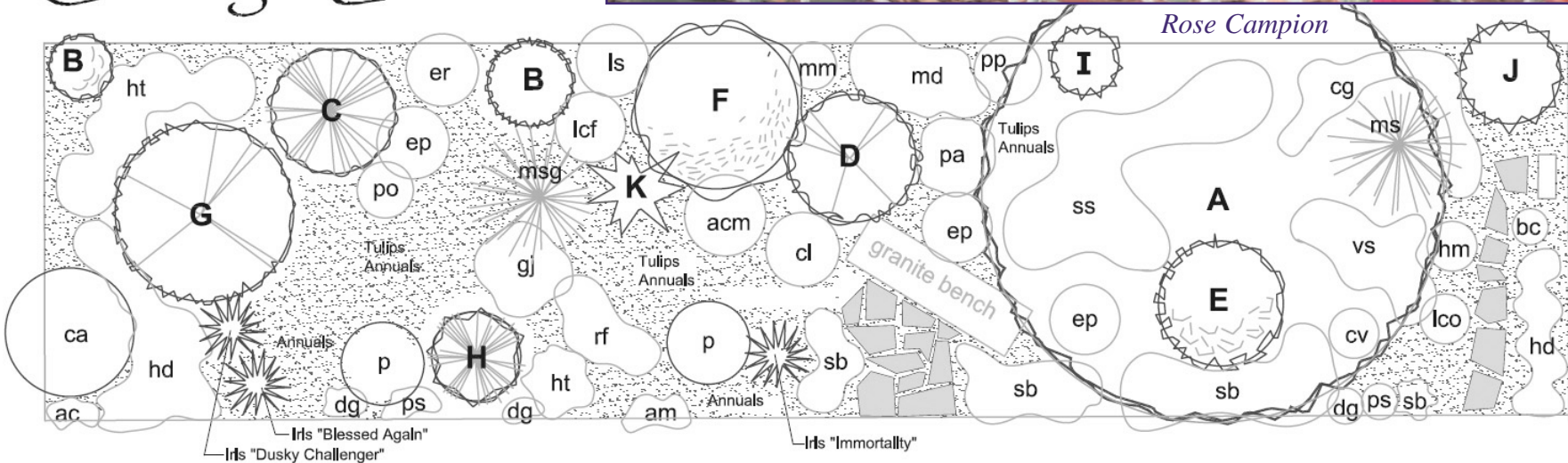

Rose Campion



Lambs' Ears



Lanceleaf coreopsis